

EXISTING LAY OUT PLAN OF IBRAHIM NAGAR COLONY SARANPUR 7

LEGEND

| | |
|-------------------------------|--|
| EXISTING RESIDENTIAL | |
| PROPOSED RESIDENTIAL | |
| EXISTING COMMERCIAL | |
| PROPOSED COMMERCIAL | |
| PUBLIC/SEMI PUBLIC FACILITIES | |
| PARK | |
| PROPOSED DUSTBIN | |
| ROAD WIDENING | |

NOTE-

1. LAND USE AS PER MASTER PLAN - MIX RESIDENTIAL
2. ROAD WIDENING NOT POSSIBLE (CHARGES AS PER GUIDE LINES SHOULD BE APPLICABLE)
3. REQUIRED PARK AREA - 385.00 SQ. M
4. PROPOSED PARK AREA - 389.00 SQ. M

INFRASTRUCTURE-

WATER SUPPLY - NOT AVAILABLE
 ELECTRICITY - AVAILABLE
 DRAINAGE - NOT AVAILABLE
 SEWERAGE - NOT AVAILABLE
 SOLID WASTE DISPOSAL - MUNICIPAL BOARD IS TAKING CARE

LEGEND

| | |
|-------------------|--|
| BUILT UP | |
| OPEN | |
| ELECTRIC POLE | |
| MOSQUE | |
| SURVEYED BOUNDARY | |
| COLONY BOUNDARY | |

NOTE

1. NO OF VACANT PLOTS 9
2. NO OF CONSTRUCTED HOUSES 28
3. TOTAL OF S L NO 1 + 2 37
4. AREA OF UNAUTHORISED COLONY 7768.7553 M.
5. TOTAL SURVEYED AREA 10643.75 M.

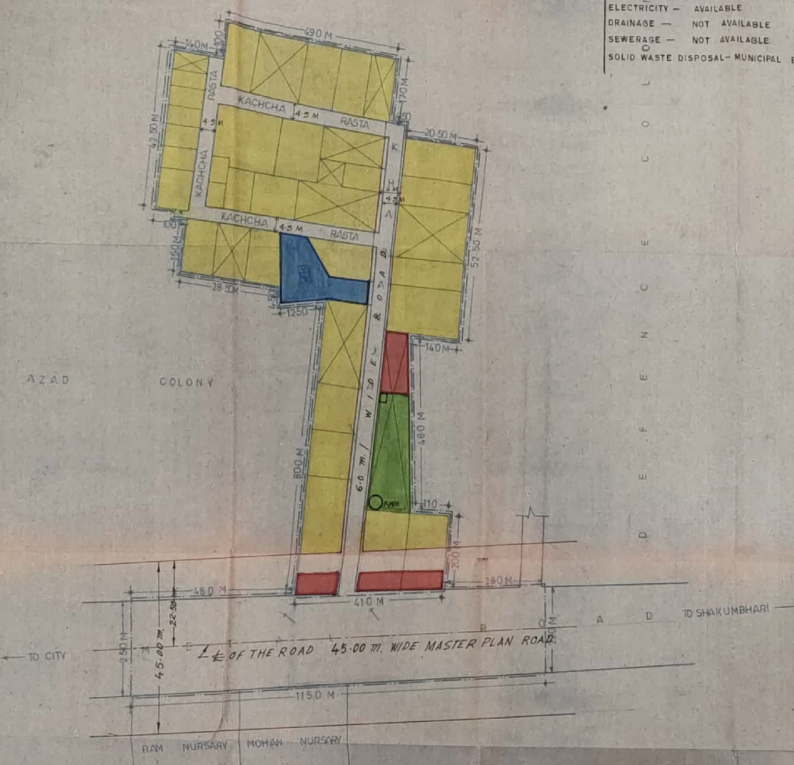
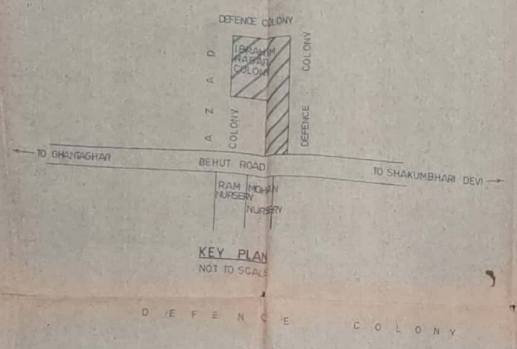

PHYSICAL SURVEY DIVISION
 TOWN AND COUNTRY PLANNING DEPARTMENT U.P. LUCKNOW

| | |
|---|--|
| | K. N. CHUBE SURVEYED BY JYOTI KUMAR BHANJI PRATAP SINGH MUNIA LAL AGARWAL |
| SCALE 1 : 500 | TRACED BY MOHD HOBIN |
| KIRTI GUPTA ASSISTANT ARCHITECT | YASHOMARA JAIN SENIOR ARCHITECT |
| RAJEEV SHARMA ASSISTANT ENGINEER | U.P. SINGH EXECUTIVE ENGINEER |